

# H20/60 Series

Heavy Duty - Increased Accuracy / 3.5 and 4.5" Hinged Ring Panel Mount



Quality Series Gauges



Marsh Instruments Quality Gauges feature the exclusive recalibrator and the accuracy is within  $\pm 1$ " in the middle half of span. These gauges provide continuous service at an economical price.

### Features:

- Recalibrator Standard on 3 1/2"
- Adjustable pointer standard on 4 1/2"
- Ranges to 20,000 psi

### Product Dimensions

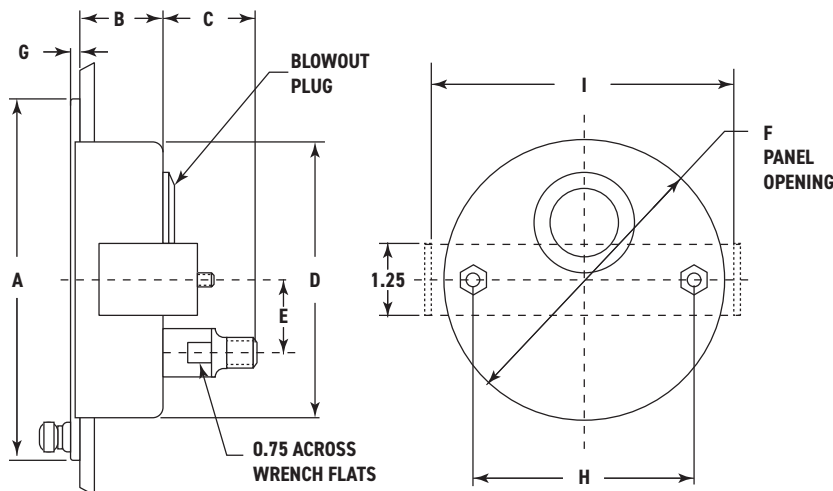

| Size | A    | B    | C    | D    | E    | F    | G    | H    | I    |
|------|------|------|------|------|------|------|------|------|------|
| 3.5" | 3.72 | 1.69 | 1.55 | 3.34 | 0.67 | 4.31 | 1.16 | 2.00 | 3.75 |
| 4.5" | 6.31 | 1.39 | 2.15 | 4.81 | 1.27 | 4.88 | 0.11 | 3.88 | 5.31 |

### Product Specifications

#### Design

Meets/Exceeds ASME B40.100

#### Accuracy

$\pm 2/1/2\%$  (ASME Grade A)

#### Dial Size(s)

3 1/2" Diameter (89 mm)

4 1/2" Diameter (100 mm)

6" Diameter (150 mm)

#### Case

Steel, Black Painted

#### Bezel

Steel, Black Painted, Removable

#### Tube & Socket

0-1,000 psi: Copper Alloy

1,500-20,000 psi: Stainless Steel

#### Movement

Stainless Steel

#### Connection

1/4 & 1/2 NPT - Hinged Ring Panel Mount

#### Pressure Ranges

VAC/Compound to 20,000 psi

#### Standard Scale

Single Scale psi

#### Dial Color

Black Markings on White

#### Pointer

Aluminum, Black Painted

#### Window

Instrument Glass

#### Standard Case Fill

Dry, Non-Fillable

#### Ambient Temperature

-40° to 160°F

#### Vent Plug

N/A

#### Weight

3 1/2" 2.0 lb

4 1/2" 2.0 lb